

The Elsworth Chronicle

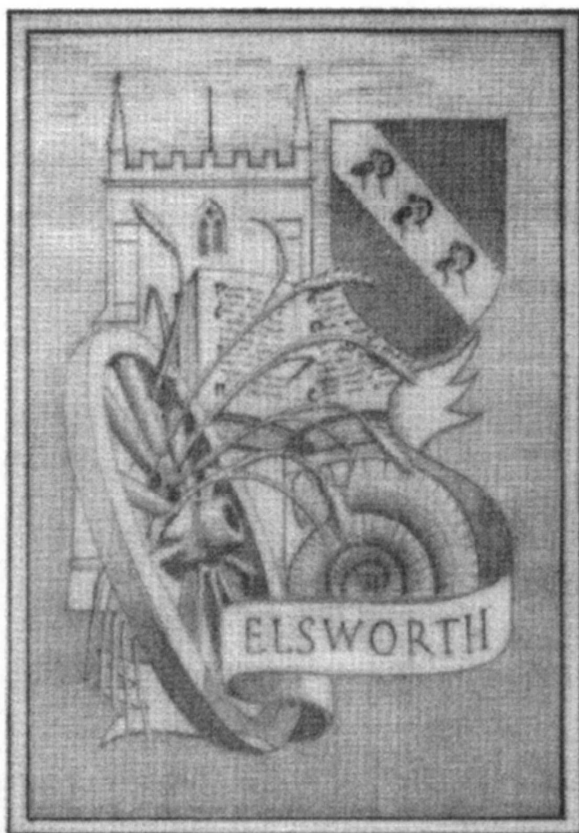

Issue No. 18

December 2004

Editor: Alan Farrow, The Old Rectory, Elsworth, Cambridge CB3 8JQ
Tel: 01954 267 472

Printers: Express Printing UK Ltd., 3 Milnyard Square, Orton Southgate
Peterborough PE2 6GX Tel: 01733 230800

Elsworth School

50 Years at Broad End

50 years back, on October 9th 1954, Elsworth School was officially opened on its present site by the Bishop of Ely. To mark the occasion this year, Catherine Lofts, the newly appointed Head at that time, joined children, staff and former staff for coffee and birthday cake on the afternoon of Friday the 8th and enjoyed being taken back half a century in the morning as staff and pupils, many attired in the style of the 1950s, rocked, rolled and jived through their assembly. Another marked highlight of the day was a most interesting exhibition embracing activities at the school over the period, which was enjoyed by many former pupils, proud parents and other interested villagers. In the evening a bonfire party, of particular appeal to many appreciative children, concluded the day's celebrations.

Of course, the school's history goes back over a further 100 years, the first building having been opened in 1847 in Brook Street, when 114 pupils were enrolled to be taught in two classrooms. However Betty Evans, in her most interesting account of this period in her series of articles in earlier editions of this magazine, noted that school attendances fluctuated wildly in the first 25 years - from 101 down to a low of 16, depending on the weather, time of year, illness and whatever was going on in the village. She quotes from the log book May 1864 -

"Very few children present, only three in 2nd class. The remainder gone to procure wheat for the Feast."

Children were admitted from two years of age and left between nine and ten years of age, when they were considered old enough to work on the land.

In the 1860/70s behaviour in the classroom was sometimes rough and unruly and could lead to on occasions to accidents. Thus Betty Evans notes that on June 19th 1864

"William Childerley was hurt by falling from the first group of desks into the Second Class."

An example of parental involvement from the same source makes interesting reading - on October 23rd 1873

"Minnie, Eliza and Martha Lovell home again from school, the mother having behaved in a very uncivil manner to the Mistress for having punished her child Minnie for inattention to lessons. The mother acknowledged herself wrong and they were readmitted".

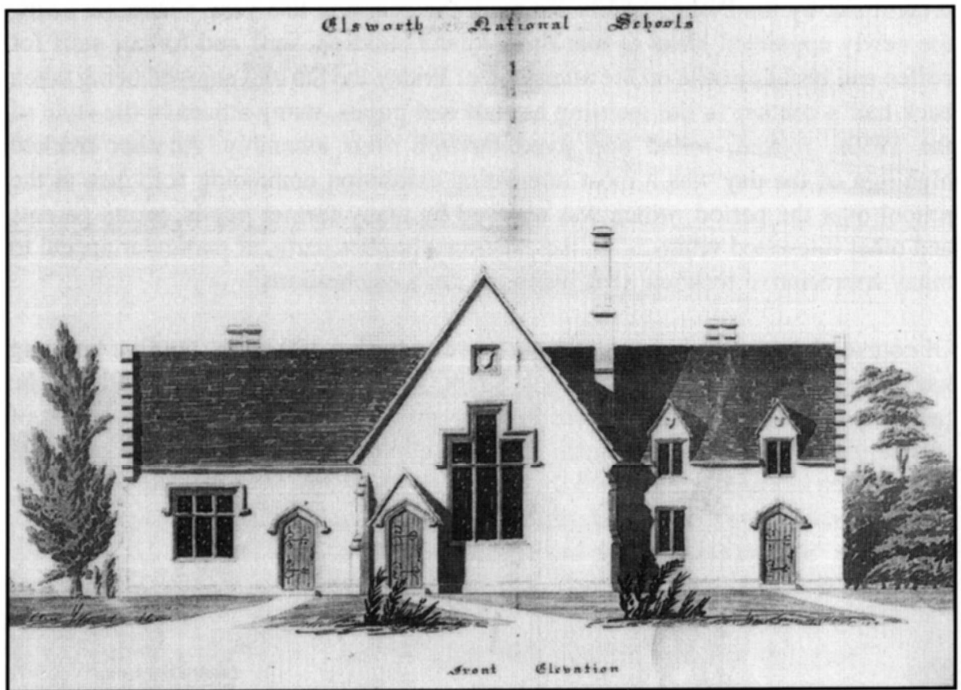

When the present building was opened in 1954 to serve not only Elsworth, but Knapwell, Boxworth and Conington as well there were 82 pupils on roll; to-day there are 140, with pupils coming not only from the villages noted above but also from Hilton and to a smaller extent from Papworth Everard, Gravely, Hemingford Grey, Over and Cambourne. The demand for places in the school is not surprising, for the quality of the education provided is recognised not only by parents, but also on national rankings - at the last SATS [school attainment tests] 100% of the pupils attained level 4 - the national target - at key stage 2 in all the subject areas, namely English, Mathematics and Science. A superb achievement. But it is not only at imparting knowledge that the school may be measured as a great success. No one entering the building can fail to be impressed by the warmth and friendliness of the school community. The school has clearly much to celebrate to mark this 50th anniversary of its opening on its present site.

AWF

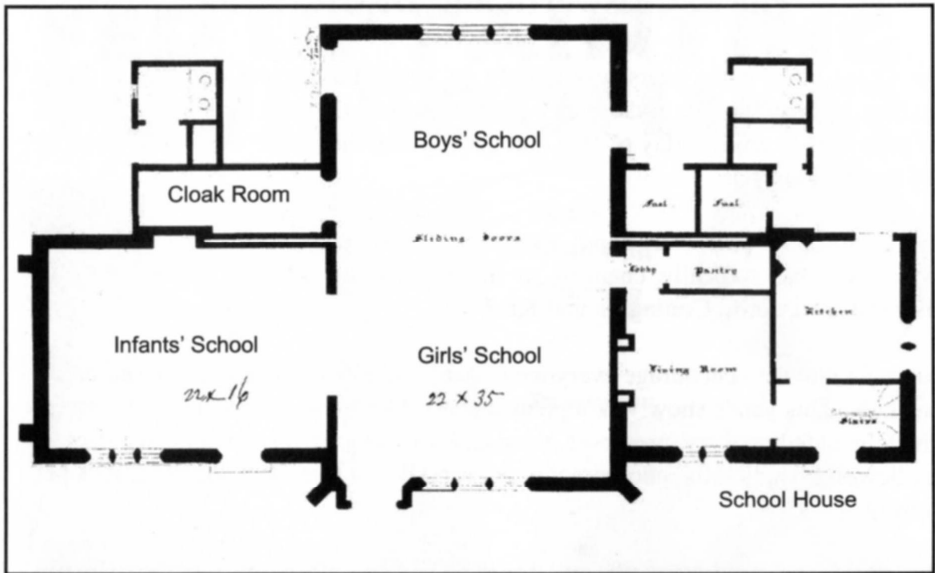

Pupils in the new School in 1954

[How many can you identify?

Clues - Roger Fensom, Norman Warboys. But who else?

The Editor would welcome findings: tel. 267472

or e-mail farrow@oldrectory16.fsnet.co.uk]

The 47th Elsworth and District Show

The Show in its early years was mainly an agricultural event comprising farm produce, garden exhibits and country pursuits which gave the rural community in the area time to enjoy a day of chat and questioning the judges decisions, good or bad (not seriously!).

The philosophy still [we hope] exists today 47 years later. Of course the programme has radically changed to involve all the interests of residents in Elsworth, Boxworth, Conington and Knapwell.

Our main aim is to encourage everyone to participate or just come along and enjoy the show: This year's show was a great success with good entries in most classes, which included cookery, preserves, wine and beer, eggs, fruit, flowers, vegetables, needlework, handicrafts, photography, art, cereals, not forgetting the children's pet show!

The attractions, entertainment, and sport during the afternoon were excellently supported by the communities from all the villages.

Any person interested in joining our committee is asked to contact Sue Chapman on 01954 267568.

Sue Chapman (Chairperson)

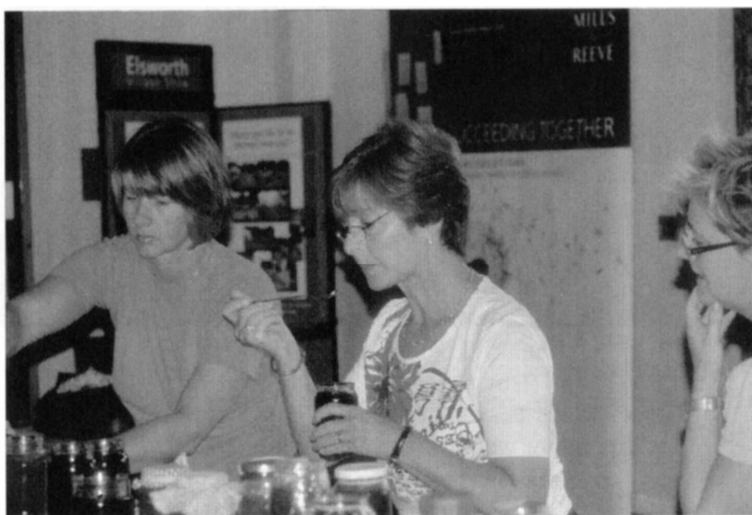

Hope Farm - Knapwell

Over the last four years, we have carefully counted the birds breeding at Hope Farm. We are delighted to have seen a steady rise in arable farmland species, including the skylark, linnet, yellowhammer and reed bunting. These have all suffered catastrophic declines in the UK in the last 30 years.

We have also noted an increase in the diversity of bird species using Hope Farm in winter. In our first full winter (2000-2001), there were 57 species.

The Government's target is to reverse the decline in farmland birds by 2020. At Hope Farm, we have not only reversed the trend already; we have seen a major increase in numbers over the last four summers. Our aim now is to encourage other farmers to use similar management techniques to reverse any declines on their farms.

Stubbles, seed and feed

The RSPB's research over many years has identified how the stubble left after cereal crops have been harvested can provide rich pickings for seed-eating birds. Cereal grains that were missed by the combine harvester - as well as the seeds of weeds that grew within the crop or after it was harvested - are a particularly valuable food source if stubble is left throughout the winter.

RSPB researchers have found that some stubble fields support many birds, while others support few. This attractiveness of different stubbles is probably due to a combination of seed density and birds' ability to access seed through the straw - i.e. how easy it is for them to move through the straw. To untangle these possible causes and develop some practical advice for farmers, we created different feeding conditions in two stubble fields. In half of each field, we cut the stubble short in late autumn. Then we spread wheat grains across half of the long and short stubble in each field in December, February and March, creating a chequered pattern. Throughout the winter and early spring, we kept a close watch on the birds using the two fields, noting exactly where they were feeding.

We have now analysed our counts. Skylarks and game birds, including up to five grey partridges, preferred the longer stubble. Fieldfares and starlings were more likely to search for insects and worms among the shorter stubble, and rooks rapidly learnt to forage where the grain had been spread. Unfortunately, there were not enough yellowhammers and chaffinches around for us to see how the length of stubble affected them. Further work will establish the best combinations of short and tall straw.

Our plan to increase the breeding productivity of skylarks by leaving small, undrilled patches in cereal crops has passed its first phase of testing by other farmers.

This is thanks to the funding and support of a consortium of government officials, research organisations, environmental bodies and the food and farming industry, working together in the SAFFIE partnership.

Reproduced by kind permission of Hope Farm

Lesley Minter, Headteacher at Elsworth, 1999-2004.

Lesley came to Elsworth to be Acting Headteacher for a term after we had struggled to find a replacement for Anne Dixon. One would have excused her for doing her bit to tide us over and returning to post in Holywell for soon after arriving she received the letter that all heads must dread - informing her of a forthcoming Ofsted inspection. She must have enjoyed it here, because she chose to apply for the job herself knowing what she would have to go through in her first year, and ended up staying for five years. It was clear to those who knew that she had an outstanding team, that the children were gifted and that the School was extraordinarily well supported by parents and the community. Lesley's first job was to produce the evidence to prove this to the Inspectors.

The Ofsted report was excellent, and the results that the children achieved improved year on year under her leadership. We learned to measure our success, not in terms of the way in which we matched up to the expected levels of attainment at ages seven or eleven, but by the number of children who were achieving Level 5's (that expected of a fourteen year old) by the time they came to leave Elsworth.

Lesley oversaw a period of sustained growth at Elsworth. This was partly as a result of a growing population, but also because of our success in the League Tables, regularly coming top in the county. She once told me that she had had an enquiry about the School, from a family moving to Cambridge from Canada. They were keen to get their children into the school and as an afterthought they asked if there were any houses for sale in the village! During her tenure the school grew in size by 30%, and Lesley was instrumental in starting the process that we hope will result in the next phase of building in the years to come.

At her final assembly, she joked about having the freedom in retirement to do as she pleased, and to enjoy her special treats such the occasional gin and tonic. A week into the holiday she met some children from School in Waitrose car park at 9.00 am on a Saturday morning. "What are you doing here, Miss Minter? You should be at home in bed with your gin!"

Thank you Lesley, for all you have done for our School, and we wish you the very best for your retirement.

James Howell Chair of Governors

A Few Words from Elsworth's New Headteacher

After so many years writing reports about pupils it seems very strange to be writing a report all about me. I was asked to write 600 words about myself earlier in the term and composed what I thought would be an excellent report, you know the sort parents would be proud to receive about their child but as is always the way this original report is now languishing on the hard drive of a now defunct laptop. Isn't modern technology liberating? So I have now re-written the 600 or so words and created the following synopsis:

Personal:

Nicholas Smith; 37 years old; married to Wendy for 11 years (proposed in an interesting way); 3 children, Emily 8, William 5 and Harriet 2; no pets; large garden; lots of chickens and a passion for 1930's cars especially Austin 7's & 10's if anyone has one tucked away.

Professional:

Geography degree from Nottingham; trained at Bishop Grosseteste College Lincoln; always worked in Cambridgeshire primary schools; taught classes consisting of every year group except reception where one needs to have great stamina to teach more than one day a week.

Specialist subject: none. As a primary teacher one has to become proficient at everything; after all it's the only job where one can paint pictures, write poetry, play football, sort out squabbles and find lost, un-named, smelly plimsolls all on one day.

Educational Values:

It has taken me years to come to the conclusion that my educational ethos can be summed up by the following three words: Learn, Love and Laugh. Need I say more?

Elsworth School:

My impressions were firmly set the first time I visited the school. It was like walking into a house and knowing that it is the one for you. It is hard to articulate what makes this school great, it's hard to express how all the constituent parts fit together to make this the successful school that it so evidently is. Having just celebrated our 50th Birthday and having spent time with Catherine Lofts, the first head, I realised that although the building may not be perfect it's the staff, pupils, governors, parents and community who all combine to make this school what it is. No matter how times have changed over the last 50 years this school still remains dedicated to learning, loving and laughing as it was in Miss Lofts time.

So that is my precis of myself. If you want to know more, or have something that might benefit the school, then please make yourself known.

Things You Will Never Hear a Man Say

The notes below are a reduced version of a piece from "Good Housekeeping" and are reproduced with permission. We are most grateful. Ladies, are they true of Elsworth Man?

I thought the bed sheets might need cleaning so I've popped them in the washing machine.

Don't worry, I've booked the babysitter for Saturday night.

I thought the red dress looked good, but there's no rush - there are plenty of other shops we can try before you make up your mind.

No, it's nothing as bad as flu - I've just got a bit of a cold.

My boss is really good at his job and quite a pleasant bloke.

You can never have too many pairs of shoes.

Actually, I think her breasts are too big.

I'm completely lost, so I'll wind down the window and ask that man for directions.

That's enough about me; tell me about you.

While I'm on my feet, is there anything I can get you?

You just relax - I'll organise our summer holidays this year.

Does my bum look big in this?

While you're away with friends I'll go to IKEA and get that self-assembly wardrobe - it'll be fixed in a couple of hours.

Don't forget its parents' evening on Tuesday and we mustn't be late.

I've written all the Christmas cards, now I'll make a list of presents to buy.

Oh good - an invitation to your second cousin's wedding. That'll be fun!

I see Brad Pitt has a new film out - fancy going to see it?

I've been totally selfish and thoughtless and I'm so sorry.

I've cleaned out the fridge, changed the cat litter and mopped the kitchen floor.

Obituary

The Rev. Hugh Mosedale

Shortly after the last edition of the Elsworth Chronicle was published, the very sad news of the death of Hugh was received. Although the funeral took place back in February, this is the first opportunity to pay tribute in these pages.

Hugh served in the parishes of Elsworth, Boxworth and Knapwell for some 35 years, during which period he was constant in his sincerity, caring nature, humility and devotion to the Christian scriptures. Without doubt, the focus of his life was the service of God in these parishes, He gave much, not only in fulfilling his role as priest, but also in unobtrusively undertaking unglamorous background tasks and in providing personal financial support to the church.

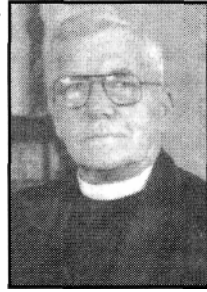

Born in 1915, Hugh experienced a varied life before being ordained in his early thirties. As a young man he had been employed as an export clerk in the City of London, but before being conscripted into the Royal Navy during the Second World War had commenced studies at King's College, London. The war years saw him as a medical orderly on destroyers on escort duties north of Scotland and on Russian convoys, with his war service ending in Benghazi in North Africa.

With the cessation of hostilities, Hugh's path into the Church was via a selection committee in Jerusalem, a return to King's College and training for the Anglican ministry. He was ordained in 1949 and his first curacy was in Liverpool. He came to us in 1961. For nine years from 1972 to 1981 he was Rural Dean of Bourn.

AWF

Jubilee Club

The Jubilee Club meets in Elsworth School Hall on the first Thursday in February, March, April, May, July, September, October, November and December at 2.30pm and everybody is welcome.

In January we look forward to visiting The George & Dragon for our New Year Meal. In June and July we have coach trips.

Our speakers over the last 12 months have included talks on Wimpole Hall, Antiques, Kentwell Hall, and Canada. We have also had informal meetings with our own members providing entertainment.

All this for only 75p per meeting, which includes afternoon tea and raffle.

Come along - you could enjoy the experience.

Betty Simcock Tel. 267470

Women's Institute

One of the first things I did when we moved into Elsworth was to join the W.I. I was a bit apprehensive at walking into a room full of strangers but I was made very welcome and as I'm still a member after 18 years. I think that says a lot.

We have interesting speakers on various subjects. This year for example we have "journeyed" along the Ouse Valley Way, been given an insight into the life and books of Beatrix Potter and learned what it is like to be a magistrate. In the Spring we look forward to "Aromatherapy at Home" and "Theatrical Make-up".

Places of local interest are visited and we enjoy a splendid Christmas Party. Our meetings end with tea/coffee and delicious refreshments. So why not give us a try and come along. Meetings are held on the second Wednesday in the month in Elsworth school hall, commencing at 7.30.

Mary Norris [Secretary] Tel .01954-267-260

Jotting from your County Councillor

During the summer a number of people contacted me to say that the last bus from Cambridge to Swavesey and Over left at 6-15pm and was no good for late working, or a drink after work. These comments surprised me because there is an evening service, subsidized by the county council and run by Huntingdon and District buses. However, on checking the timetable at one of the stops, the last bus was indeed shown as 6-15. I gather this has now been corrected, but it does emphasize the importance of up-to-date and reliable information. Hence.... have mouse - will travel.

Cambridgeshire County Council has played a major role in establishing an East Anglian phone service (known as Traveline East Anglia), which provides public transport information covering the whole country. Traveline is part of a national service available from anywhere in the UK via a single telephone number. Calls are charged at national rate (i.e. 12p per call). However, more recently the service has become available on the web.

This means that it is now possible for members of the public to plan regional and national bus, coach and rail journeys. Simply provide details of where you wish your journey to start, where you'd like it to end and the journey planner will provide you with several options on how to make your journey.

So, place-to-place routes, journey times and full descriptions of where to get on and off are now all available at the click of a mouse. Or, if you'd prefer, give Traveline a call on 0870 608 2 608, or visit the web site www.traveline.org.uk by clicking on East Anglia on the map.

We are still working on the introduction of real time bus information - like the London Underground -and are piloting a text messaging service on the Ely to Cambridge route. All of this is aimed at providing much better information about services and is part of our commitment to improving public transport in Cambridgeshire.

I am always available for consultation, either in person or by phone, letter or e-mail. I can be reached at the address or telephone number below.

Shona Johnstone, Highfield, 5 Lowburyholme Road, Over, CB4 5NP
Tel: 01954 230565 e-mail: shona.johnstone@cambridgeshire.gov.uk

More Help for Young Homeless

South Cambridgeshire District Council and Cambridge City Council are working with the YMCA to provide emergency accommodation for young people in need.

Following a pilot scheme, a five-year Service Level Agreement with the YMCA on Gonville Place in Cambridge has been drawn up to provide emergency bedspace for young homeless people in Cambridge and South Cambs.

Under the agreement the two district councils have permanent use of a bedroom at the centre, which can be used to provide immediate accommodation for a young person who becomes homeless.

South Cambridgeshire District Council's Homeless Strategy has a focus on homelessness prevention. The Council supports Cambridge and District Community Mediation Service in their work with young people. Mediators work to improve communication between young people, who are thinking of leaving home and their parents or carers, to try to resolve problems and find solutions.

Councillor Liz Heazell, portfolio holder for housing, said, "We are extremely pleased to announce this five-year partnership with Cambridge City Council and the YMCA. The YMCA provides supported housing for young people and opportunities for them to develop new skills. It is a much better alternative to housing a single young homeless person in bed and breakfast accommodation. Coupled with support available from Cambridge and District Community Mediation Service, this improves the service we offer to young homeless people or those at risk of becoming homeless."

For further information please contact Jo Fowler, communications officer at South Cambridgeshire District Council on (01954) 713289, mobile 07887 633640 or email Lanne.fowler@scambs.gov.uk

Elsworth NWR

Elsworth NWR (National Women's Register) is a very active group with members from Boxworth, Conington, Hilton and Papworth Everard as well as from Elsworth.

Members decide upon topics every six months resulting in a very varied programme. Recently we had a talk by the area co-ordinator of the East Anglian Air Ambulance and the next meeting involved a harvest supper with the theme of harvest food and customs. Evenings involving food and drink are always popular!

On 17 November 2004 we are having a telephone treasure trail quiz organised by another NWR group; this is a national quiz involving NWR groups from all over the country. In December we hold our Christmas party where members contribute the food and drink.

I hope the above will give you some idea of the serious and not so serious evenings we organise and that you will be encouraged to join us. If you have recently moved to the area this is an ideal way to meet new people For further information please contact either Shirley Emmerson (01954 267583) or Gill Barnes (01954 267524).

Shirley Emmerson, Local Organiser

South Cambridgeshire Waste Collections

Christmas

South Cambridgeshire District Council has suspended green wheeled bin collections and diverted resources to collecting black wheeled bins the week before Christmas and the two weeks after New Year's Day. The increased black bin collection should alleviate the need for excess/side waste.

Kitchen Waste

It might not be generally known, that from this last summer kitchen waste may be put into the green wheeled bin. Residents may now recycle:

cooked food; fruit and vegetable peelings; old fruit and vegetables; eggshells; stale bread; tea bags; coffee filters; meat, fish bones and food carcasses

as well as the usual grass cuttings, leaves, prunings and clippings, untreated wood bark, cardboard; catalogues, shredded paper and yellow pages; brown paper, rabbit and guinea pig waste.

Kitchen food waste may also be placed in the green bin one week and the black bin the following week thus effectively having a weekly collection of this food waste.

Cambridge and District Citizens Advice Bureau

Free Legal Advice in Cambridge

Several prominent local solicitors have agreed to provide free legal advice sessions for Citizens Advice Bureau clients. They will be held on the first Tuesday of each month, starting at 6.00 p.m. at 72-74 Newmarket Road.

The service will be by appointment in order to ensure there is no conflict of interest, and the client's problem is already clearly defined. The clients will therefore need to see or speak with an adviser beforehand, who will help them consider their various options. The adviser will then book an appointment where necessary.

Help In Dire Situations

Residents in Cambridge City and County are fortunate in having charities that will respond quickly to an emergency. Citizens Advice Bureaux have come to rely on The Salvation Army being able to rustle up a food parcel at a moments notice. A lesser-known charity is Cambridge Central Aid Society who will raise one-off grants towards such essentials as cookers or basic furniture and bedding.

We hope you will respond generously to the Salvation Army's annual fund raising appeals. **Contributions** to Cambridge Central Aid can be addressed to them c/o 72-74 Newmarket Road, Cambridge, CB5 8DZ. This charity works closely with Cambridge- CAB who will check an applicants status, including potential benefits, tax credits and other entitlements and can then give the charity's Trustees an accurate assessment of what is needed and why.

If you wish to know more please contact Central Aid at the above address.

Dates for your Diary

4th	December	Football - Sawston Rovers Reserves at home.
18th	December	Cambridge Un. Press at home.
11th	January	NWR - Literacy Quiz
12th	January	WI - Aromatherapy
15th	January	Football - Camden United at home.
29th	January	Football - JM Sports at home.
3rd	February	NWR - planning meeting.
5th	February	Football - Linton Granta at home.
8th	February	Jubilee Club - 2.30 at Elsworth School
9th	February	WI - Theatrical Make-up
28th	February	NWR - Advertising over the Ages
3rd	March	Jubilee Club - 2.30 at Elsworth School.
5th	March	Football - Steeple Bumpstead Res. at home.
9th	March	WI-AGM
19th	March	Football - Saffron Crocus Res. at home.
7th	April	Jubilee Club - 2.30 at Elsworth School.
13th	April	WI at Elsworth School - 7.30
23rd	April	Football - Hundon Res. at home.